

## TT600 Eletronic Toothbrush User Manual

TPC-01WB

### IMPORTANT SAFETY INSTRUCTION

**Please read all instructions before using. When using electronic products, especially when children are present, the following basic safety measures should be observed.**

1. Do not use accessories not recommended by Tranqwil.
2. Do not plug the charger into the adapter with unspecified voltage. This product is designed to work with USB 5V (Note: This charger is not water proof)
3. If any part (brush head, brush handle, charger)of the product is damaged, please stop using it.
4. Please use this product according to the intended use described in this manual or the recommendation of dental experts.

### Medical Warning

1. If you have had oral or gingival surgery within two months. Please consult your doctor/dentist before using this product.
2. Please consult your doctor/dentist if there is massive bleeding in gums after using this product, or bleeding after 1 week.
3. If you feel uncomfortable or painful, please stop using this product and contact your doctor/dentist.
4. This product meets the safety standards of electromagnetic devices. Please consult your doctor or Tranqwil before using any problems involving cardiac pacemakers or other implanted devices.

### PRODUCT INTRODUCTION

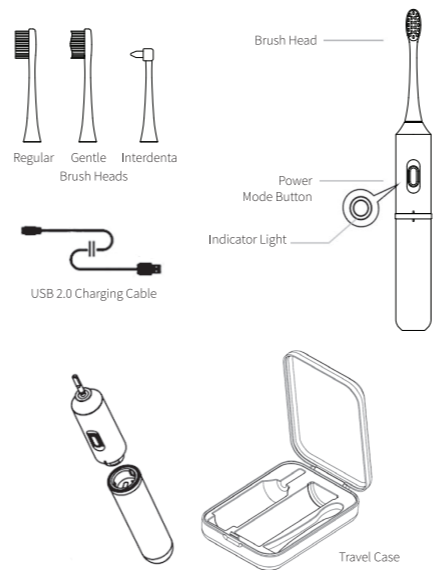

Product Size  
247 x 26 mm



Rated Input Power  
1.5W



Rated Voltage  
5V



Material  
ABS, PC

### Install The Toothbrush

1. Connect the top handle (power button) and the bottom handle (battery part) by aligning the two vertical marks on both handles as shown in the below figure. When the two handles are successfully connected, the indicator light on the power button would flash once.

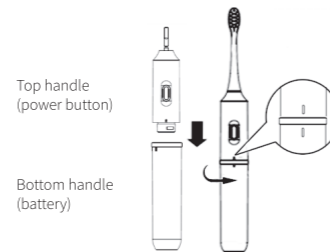

2. Install the brush head to the brush handle. Make sure the bristle side faces toward the power button side.
3. Press the brush head down on the metal shaft until it can't be pressed down anymore.

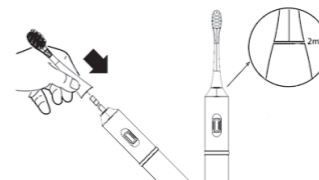

### How to Charge Toothbrush

1. Uninstall the toothbrush by wrenching the top handle and bottom handle. Then plug the charging cable into the type C port on the bottom handle.
2. Connect the USB power cord to your any power adapter like a mobile phone charger or mobile power supply. The indicator light locates on the opposite side of bottom handle will turn yellow, which indicate it's charging.
3. Please keep clean and away from water while charging.

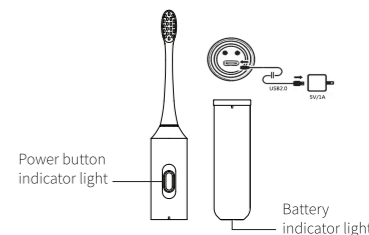

### Charging Indicator Light

- The power button indicator light flashes for 10 seconds which indicates that the battery is low. Please charge .
- The battery indicator light turns yellow indicates that the battery is charging.
- The battery indicator light turns green indicates that the battery is fully charged.

**When using the toothbrush for the first time: If there is electricity left, please use it until next charge. In order to ensure the battery lifetime, it is recommended that the battery should be fully discharged once every six months.**

## Quick Start Guide

### Start Using

Connect the top handle and the bottom handle by aligning the two vertical marks on both handles. When the two handles are successfully connected, the indicator light of the power button would flash once.

### 5 Brushing Modes

- Low speed cleaning mode (Yellow light)
- ↓
- Medium speed cleaning mode (Light blue light)
- ↓
- High speed cleaning mode (Blue light)
- ↓
- Whitening mode (Light yellow light)
- ↓
- Massage mode (White light)

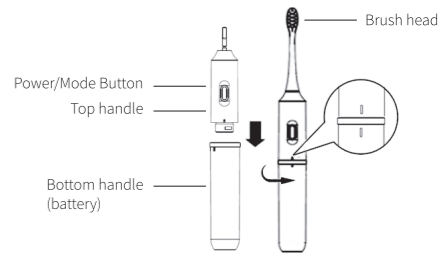

### Troubleshooting

PROBLEMS	POSSIBLE CAUSES	SOLUTIONS
Vibration Intensity Decrease	Excessive toothbrush pressure	Gently place the brush head on the teeth.
	The gap between the brush head and the main body is too wide or too small	Re-install the brush head again. Contact Tranqwil customer if the issue has been solved.
Toothbrush does not work	Insufficient charging time	Please charge the battery fully
	Has not used a toothbrush for more than 1 year	Contact Tranqwil for battery replacement
	The battery has reached its lifetime	



For all comments, questions or complaints, please reach out to us.

Email: [hello@tranqwilhome.com](mailto:hello@tranqwilhome.com)

Website: [Tranqwilhome.com](http://Tranqwilhome.com)

### Brushing instructions

- Apply a small amount of toothpaste to the wet bristles, put the brush head into mouth then press the power button to start, so as to avoid the toothpaste splashing.
- Place your toothbrush at a 45-degree angle to the gums.
- Gently apply pressure while brushing your tooth
- Follow the 2-mins timer to brush the outer surfaces, the inner surfaces, and the chewing surfaces of the teeth.

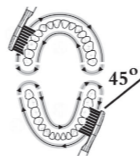

### Cleaning and Maintenance

#### Cleaning brush head

- Please clean the brush head after each use and air dry it.
- Don't pull the bristles to avoid deformation and falling off.

#### Replace brush head

Brushing your teeth is an important part of your dental care routine. For a healthy mouth we recommend you to replace your tooth head every three or four months, or sooner if the bristles are frayed. A worn toothbrush won't do a good job of cleaning your teeth.

#### Clean the handle

- Scrub with soft cloth and air dry it
- Do not immerse it in water for a long time
- Do not clean with water higher than 40C or acidic cleaner.

### 5 Brushing Modes

- Press the power button to turn on the TT600 toothbrush.
- Switch between 5 modes by pressing the power button.
- Once the mode is operating more than 8 seconds, the toothbrush would memorize the mode, and directly enter the mode next time you use it.

#### Indicator Lights & Brushing Modes

- **Yellow light:** Low speed cleaning mode
- **Light blue light:** Medium speed cleaning mode
- **Blue light:** High speed cleaning mode
- **Light yellow light:** Whitening mode
- **White light:** Massage mode

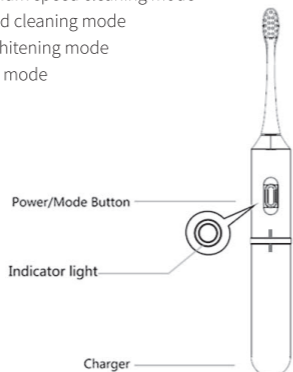

Note: This device is IPX7 waterproof. The handle and brush head bristles can be washed with water after using. But the waterproof performance of IPX7 does not include protection against hot water and steam, and cannot be used showers and baths.

### How to Charge Toothbrush

- Uninstall the toothbrush by wrenching the top handle and bottom handle. Then plug the charging cable into the type C port on the bottom handle.
- Connect the USB power cord to your any power adapter like a mobile phone charger or mobile power supply. The indicator light locates on the opposite side of bottom handle will turn yellow, which indicate it's charging.
- Please keep clean and away from water while charging.

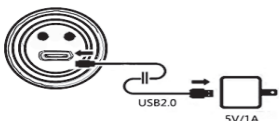

### Charging Indicator Light

- The indicator light of power button flashes for 10 seconds which indicates that the battery is low. Please charge.
- The yellow light indicates that the battery is charging.
- The green light indicates that the battery is fully charged.

When using the toothbrush for the first time: If there is electricity left, please use it until next charge. In order to ensure the battery lifetime, it is recommended that the battery should be fully discharged once every six months.